

Manufacturers of PP strap, machinery & packaging Accesories.

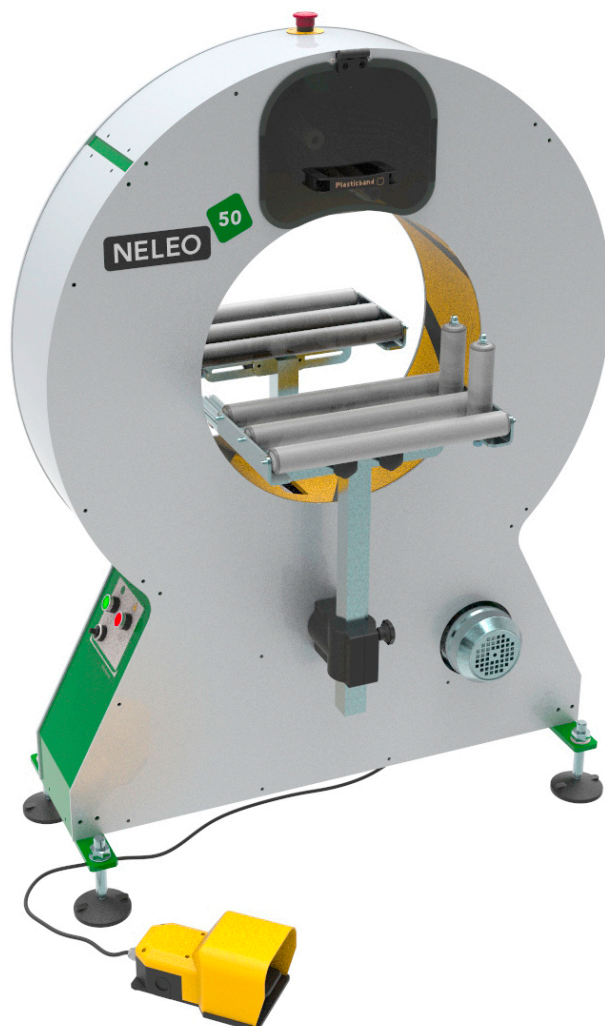

# NELEO

User guide 



V07/21

## INDEX



*Translated from Spanish*

1. Introduction.
2. Technical machine specifications and noise emissions.
3. Main components.
  - 3.1. Spool holder hoop.
  - 3.2. Spool holder.
  - 3.3. Access door.
  - 3.4. Control panel.
  - 3.5. Footswitch.
4. Safety instructions.
5. Set up.
6. Electrical panel operating.
  - 6.1. Master switch.
  - 6.2. Emergency stop button.
  - 6.3. Control speed.
  - 6.4. Reset button.
  - 6.5. Operating mode selector
7. Adjustments.
  - 7.1. Spool's loading in the machine.
  - 7.2. Threading the film (For configuration with cutting system).
  - 7.3. Stretchfilm tension adjustment.
  - 7.4. Stretchfilm density adjustment.
  - 7.5. Package dimension adjustment.
  - 7.6. How to wrap a product?
8. Maintenance.
9. Breakdowns.
10. Component list and spare parts.
  - 10.1. Component list.
  - 10.2. Spare parts list for N50 and N90
11. Electrical outline.
12. Pneumatical outline (For configuration with cutting system).

**START**

# 1 Introduction



We thank you for choosing the **NELEO 50, 90** machines. This well-known model is technologically advanced and easy to manage. For a better development of your **NELEO 50, 90** machines, please read carefully this manual. It is the customer responsibility that all staff allowed to work with this machine and maintenance technicians read and understand this manual, especially the safety instructions. This machine has been designed to wrap products with stretchfilm in a horizontal way. Any other use than **the explained is not agreed by the manufacturer.**

For a better performance of the orbital wrapper, should be used Plasticband's original stretchfilm, produced under your equipment specifications. Besides to enlarge your machine life, will avoid breakdowns because using stretchfilm not good enough.

## **IMPORTANT! Do not throw away this manual**

1. Be sure to have read deeply all the instructions before switch on the machine.
2. For a better use of this machine we suggest using film "**FIBAND**".
3. This machine can only be used by specialized staff.
4. Before checking, cleaning or adjusting the machine, switch off the electrical wire.
5. Do not introduce your hands or any other body parts between the belt and the engine.
6. Do not annul the safety micro switch placed on the window

## 2 Technical machine specifications and noise emissions

		<b>NELEO</b> 	<b>NELEO</b> 
Weight		150 kg	185 kg
	Height	1410 mm	1705 mm
	Width	1000 mm	1410 mm
	Length	425 mm	500 mm
Film quality		Fiband F10,23,1300	
Film width		100 mm	166 mm
Film thickness		17, 20, 23 y 30 micras	
Working tension		220v / 240v 50Hz	
Maximum product size		345x345xL (mm)	625x625xL (mm)
Maximum noise level		70 dB	

In compliance with annex 1 of the Machinery Directive **2006/42/CE**, Plasticband, S.A. declares that the noise emitted by this machine is within the limits of the above mentioned legislation which provides a maximum of 70dB (A).



## 3 Main components

### 3.1 Spool holder hoop

It is the rotation element that wraps the product on which the spool holders are mounted. It is mounted on four or five bearings (depending on model) for silent running, driven by an electric motor via a V-belt of low maintenance and wear.

### 3.2 Spool holder

It is carrying the stretch film spool and is provided with:

- An axle for fitting the stretch film spool
- A roller with a progressive breaking device of the stretch film spool, in order to give more or less tension to it.
- Two gravity roller.

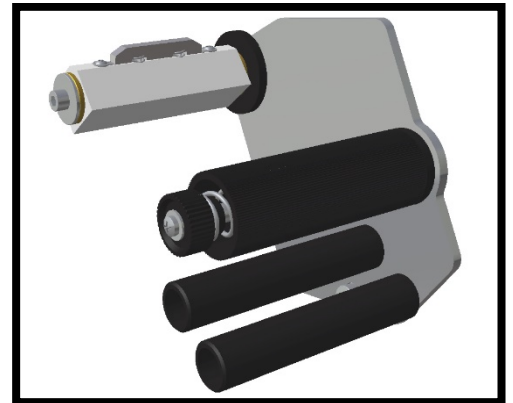

### 3.3 Access door

This allows the change of the stretch film roll, as well as access to the tension adjustment device located in the spool. The access door is provided with a safety microswitch which interrupts the maneuver operation of the machine when it opens.



### 3.4 Control panel

It is provided with all the control elements:

Panel control with different push-buttons, pilot lamps, and an emergency stop push-button with a red visual signal.



### 3.5 Footswitch

The pedal is covered by a protection to avoid the machine to starts unintentionaly. Pressing it the ring will turn around.



## 4 Safety instructions

The wrapping machine **NELEO 50, 90** has been designed and made to guaranty the maximum safety during its use.

1. Before using this machine, consult the manual use.
2. Do not work in explosive environment.
3. Do not use water o water steam to clean the machine.
4. Only use Plasticband's spare elements. If not, Plasticband can cancel its guarantee.

## 5 Set up

To install the **NELEO 50, 90** machine, follow the steps, as follows:

1. To place the machine in the choosed place.
2. To adjust the feet to the working desired height.
3. To adjust the gravity rollers tables to the desired height.
4. To adjust the vertical gravity rollers to the desired width.
5. Connect the machine to the power supply and compressed air.
6. Place rolls stretch film.
7. Now the machine is ready to begin work.

## 6 Electrical panel operating

CONTROL PANEL - The panel control is placed in the left-hand side cover and its composed of:



### 6.1 Master switch

Push botón (ON/OFF): it operates as master switch.



### 6.2 Emergency stop button

This button is placed in the upper part of the machine. In any situation, just pressing this button will stop automatically the machine.

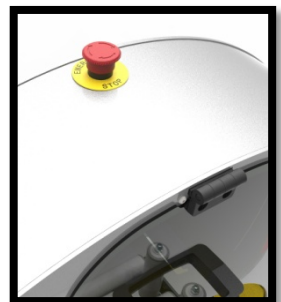

## 6.3 Control speed

It is the speed regulator of the spool holder, with which you can adjust the density of stretchfilm to put onto the products. Increases or decreases the speed of the hoop (faster/lower work).



## 6.4 Reset button

The Reset button is a safety system which avoids machine working after a tension fail. This button must be pressed after this situation for continuing working, or when stop has been used or when opening the door acces.



## 6.5 Operation mode selector (only switch SCN)

- 1- **Automatic mode:** Press the pedal and release it immediately. The operation of the ring begins until it is pressed again to stop it and to activate the cutting system.
- 2- **Standard mode:** Press the pedal and release it immediately. Threading will be done. Keeping the pedal pressed, the ring acts until it is released and the cutting system is activated.
- 3- **Banding mode:** Each time the pedal is pressed, a complete banding cycle is reactivated. Depending on the speed we get more or less layers of film (at minimum speed 4 film layers are made).

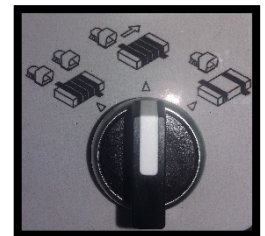

## 7 Adjustments

### 7.1 Spool's loading in the machine

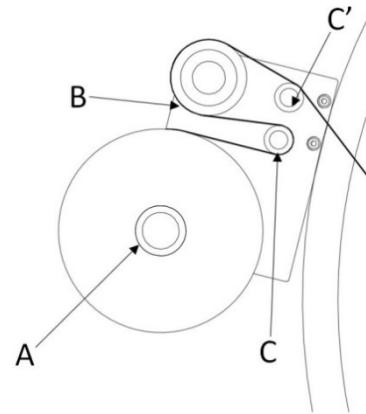
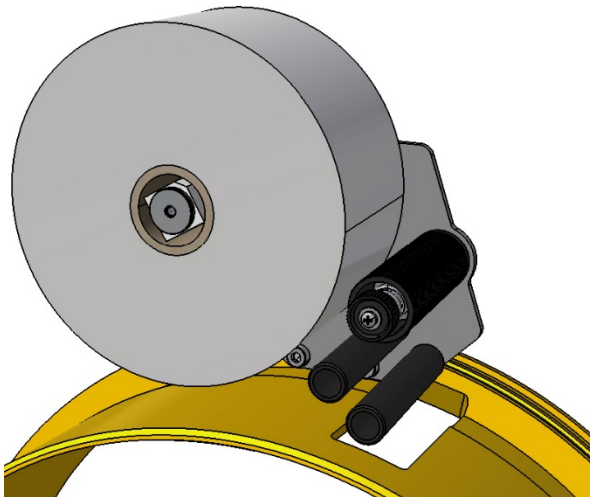

1. Open the window and remove the empty tube roll film spool (A).
2. Place a new roll of film in the spool shaft so that the end of the film comes out of the top right hand side.
3. Take the end of the film and pass it over the tensioning roller (C), then pass under the roller brake (B) enveloping it, pass it through the upper part of the tensioning roller (C') and finally, enter the film into the center ring of the machine through the opening of the protective ring.
4. Close window.

**Important:** For the proper functioning of the machine, insert the coils tubes to the end of the spool holder to prevent possible damage to internal components of the machine.

Plasticband recommends working with two coils simultaneously and keep them with a similar amount of film in order to prevent the machine from moving while turning at high speed.

### 7.2 Threading the film (for configuration with cutting system)

To make the thread of the machine, the two rolls of film should be tied by the end part to stretch out through the holes in the protection ring in the center of the bobbin and pressing the pedal to start the cycle

machine and the film is threaded. Optionally, to save time, you can hold the ends of the stretch film to wrap the product with your hand and press the pedal. When you release the pedal, the coils are automatically threaded.

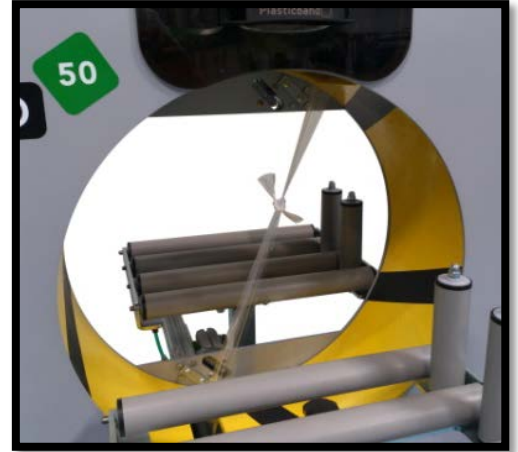

### 7.3 Stretchfilm tension adjustment

To reach the wished stretchfilm tension, it will be enough by turning round the tension control (see picture), to the right way for higher tension, and the inverse to less stretchfilm tension. Adjusting the tension, we get a higher pressure onto the product. Moreover, we also get a stretchfilm tension and therefore a saving of it.

**Caution:** The excessive stretchfilm tension could cause constant breaking.

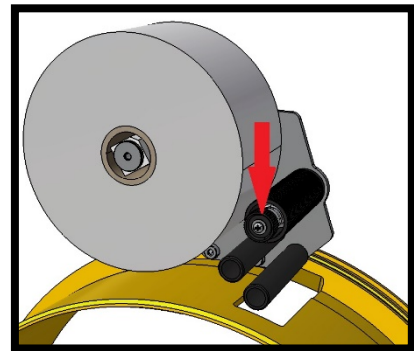

### 7.4 Stretchfilm density adjustment

To reach the density level of the stretchfilm on the package, act on the entry package speed. Reduce it for a higher density and increase it for a lower density of the stretchfilm.

## 7.5 Package dimension adjustment

To reach an optimal packaging is important to adjust the position of the gravity rollers tables. To adjust the height of the gravity rollers table to lose the handle (see picture) placed under the tables and adjust them to the desired height. For greater durability of the tape measure, we recommend opening the handles well before making the adjustment.

The ideal height would be the one that allows to center the product in relation with the hoop diameter.

Moreover, the vertical gravity rollers should also be adjusted in the way that the products are guided while pushing for wrapping and so avoid movements which could bring up film breakage.

## 7.6 How to wrap a product?

- a) First of all, we will take the stretchfilm end which comes from the hoolder spool and must be placed onto the package to wrap, **holding it with your hand** and doing a light pressure onto it.
- b) Then we will push the electrical pedal, without unfasten the stretchfilm end, until the first laps fasten that end.
- c) After that, it is not necessary to fasten the stretchfilm end and we can begin to feed the package onto the horizontal gravity rollers and through the hoop.
- d) Once the wrapping has finished, we will unfasten the electrical pedal and when the hoop will be stopped then we will cut the stretchfilm with the finger or with a cutter.



## 8 Maintenance

Specialized staff can only repair this machine.

To repair and to do maintenance, switch off the machine from power supply.

Use the appropriate tools. Never adjust, repair or grease the machine while it is working. Do not work in explosive environment.

### PREVENTIVE MAINTENANCE

ELEMENT	TYPE	ACTION	FREQUENCY
Machine set	Maintenance	General cleaning.	6 months
Machine set	Control	Review of screwed unions.	3 months
Transmission belt	Control	Revise tension and wear.	3 months
Transmission belt	Maintenance	Change every 5 years or if it shows wear in the revision.	
Motor	Control	Control fixing, break, oil.	6 months
Buttons / security micros	Control	Check proper functioning.	2 months
Footswitch	Control	Check proper functioning.	1 month
Spool holder	Control	Review of screwed unions.	3 months
Spool holder	Maintenance	Revise and clean the traces of stretchable film.	1 month
Greasing	Maintenance	According to description.	6 months



Perform a general review and maintenance of the machine every 12 months for Plasticband's after-sales service.

### Greasing.

Remove the old grease with a brush before putting new one in the following parts:

1. Ring bearings.
2. Bearing of the belt tension pulley.
3. Ring bearings guide.

**Important:** Do not put grease in the belt guide, it could cause that belt slide as well as that ring would not turn.

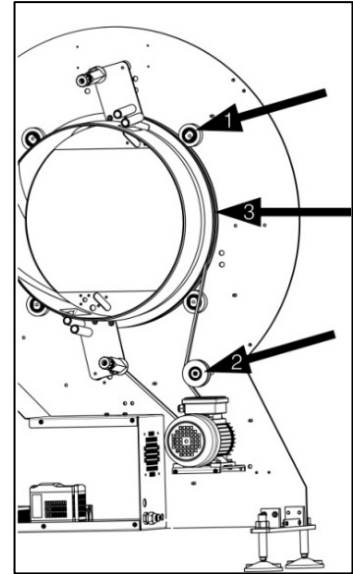

### PLASTICBAND AFTER SALES CUSTOMER SERVICE

Phone: +34 938 495 722  
Mobile phone: +34 630 299 839  
@ [service@plasticband.com](mailto:service@plasticband.com)

## 9 Breakdowns



SYMPTOM: Machine blockaded.	
CAUSE	SOLUTION
1. Some safety device activated.	1. Push RESET button. Check that window is closed.
2. Blockade of the frequency variator.	2. Stop the machine for 20 seconds.
3. Automaton (PLC) out of sequence.	3. Stop the machine for 20 seconds.
4. Worn-out fuses.	4. Substitute fuses placed in the electrical box.
5. The spool holder hoop's transmission belt slips.	5. Tighten the belt with the tensor screw.



SYMPTOM: Stretchfilm often breakage.	
CAUSE	SOLUTION
1. Stretchfilm regulation control too pressed.	1. Pressure disimintion.
2. Too much speed in the material entry.	2. Reduce speed.
3. The product is uncentred in relation to the hoop center.	3. Centre the product with the entry/exit gravity rollers tables and with the vertical rollers.
4. Too much ring speed.	4. Reduce ring speed.

# 10 Component list and spare parts

## 10.1 Components list

- Framework set

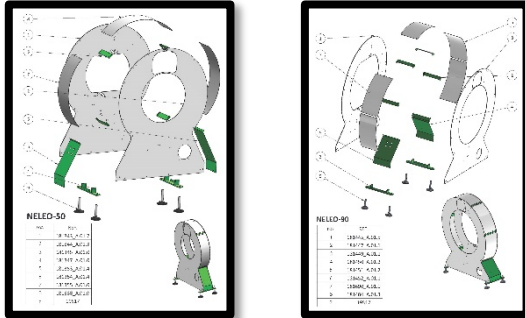

- Transmission set

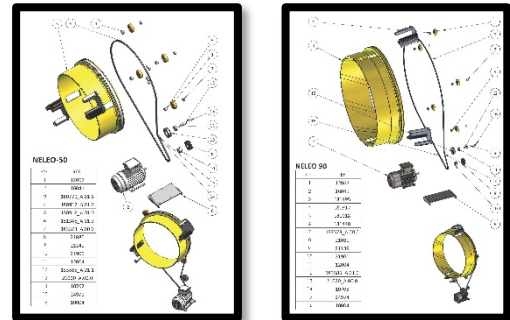

- Spool holder set

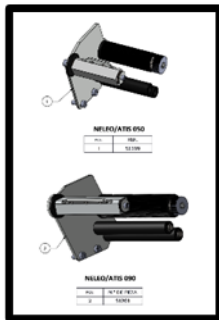

- Safety closing set

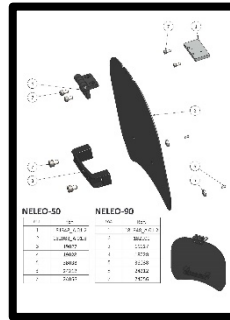

- Control panel

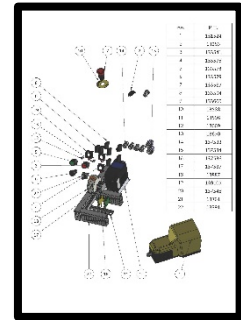

### Optionals

- Gravity rollers table

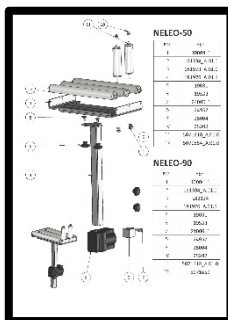

- Cutter set

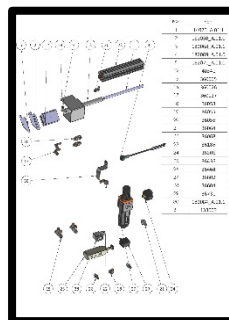

- Short products bridge

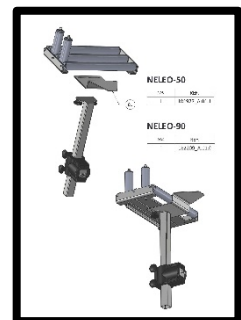

- Manual top presser

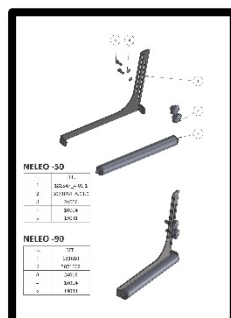

- V rollers



- Framework set N50

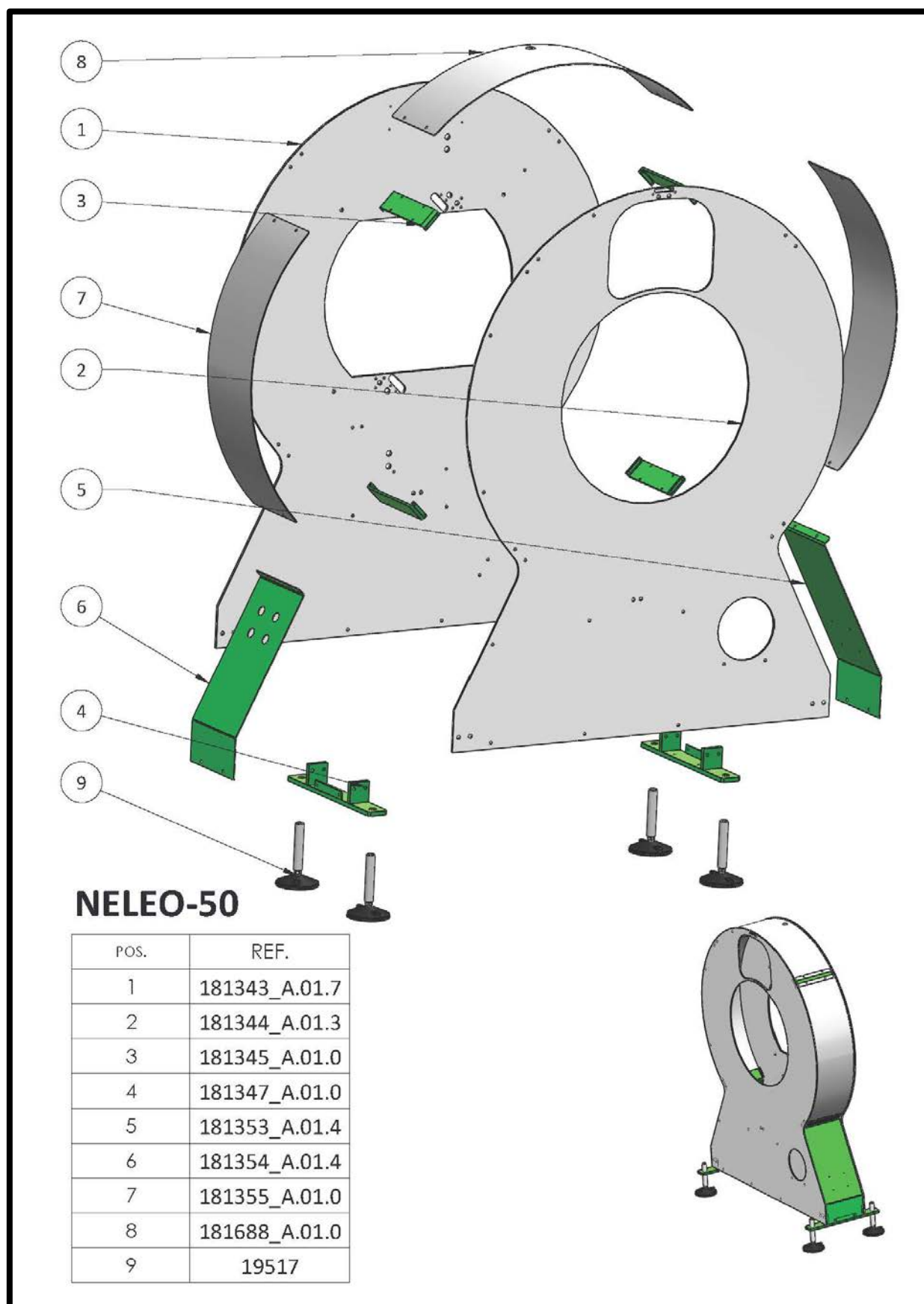

- Framework set N90

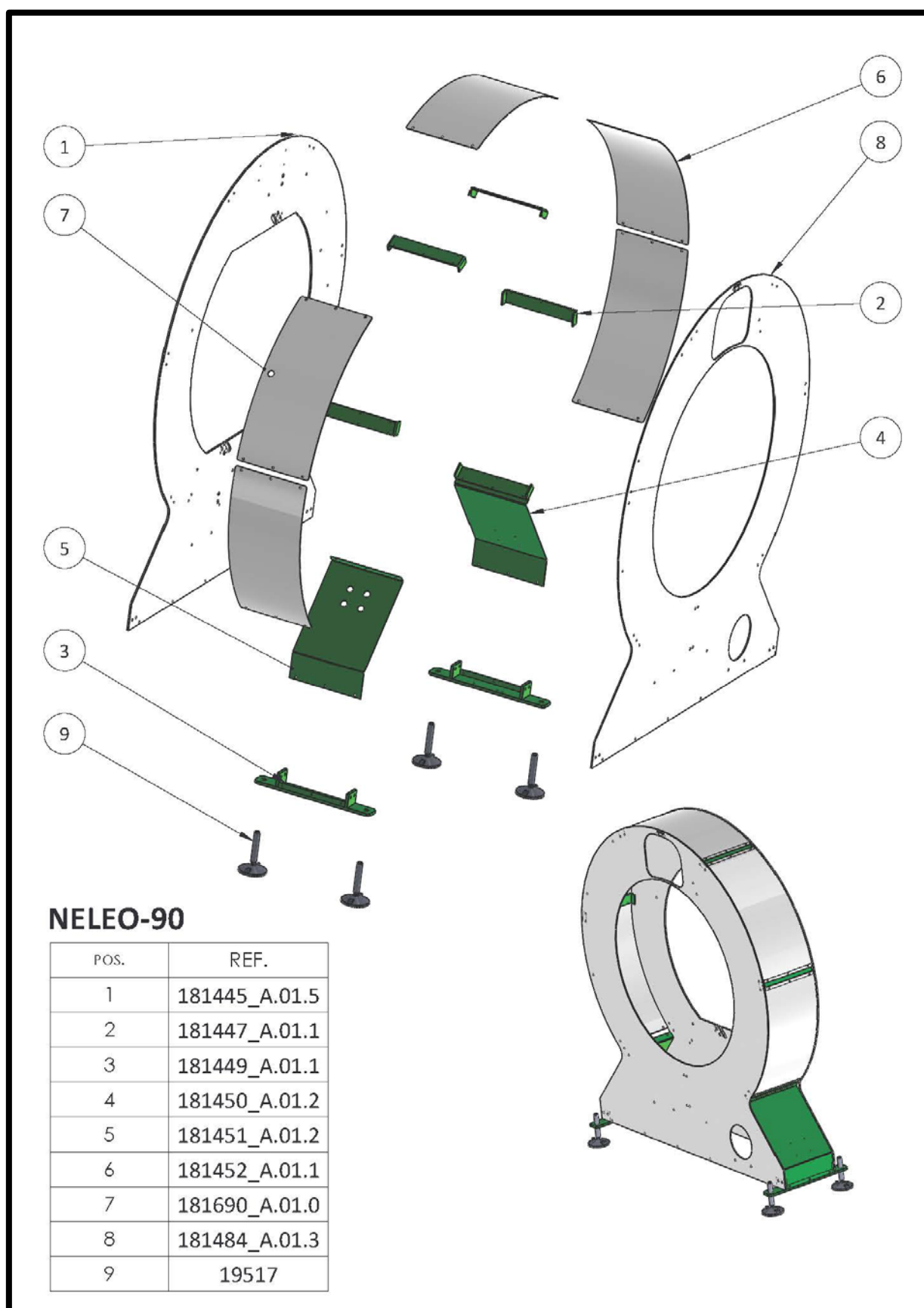

- Transmission set N50

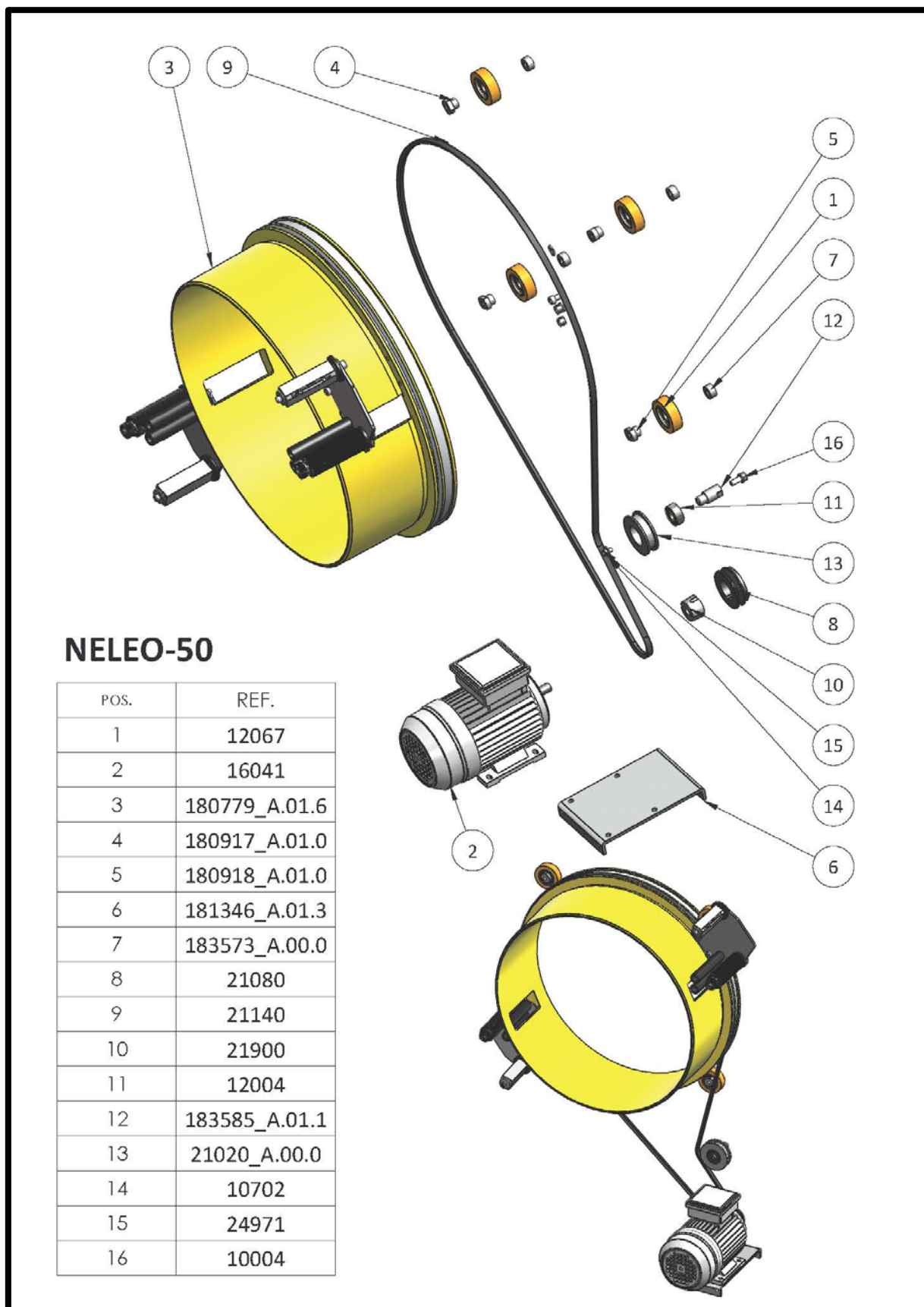



- Transmission set N90

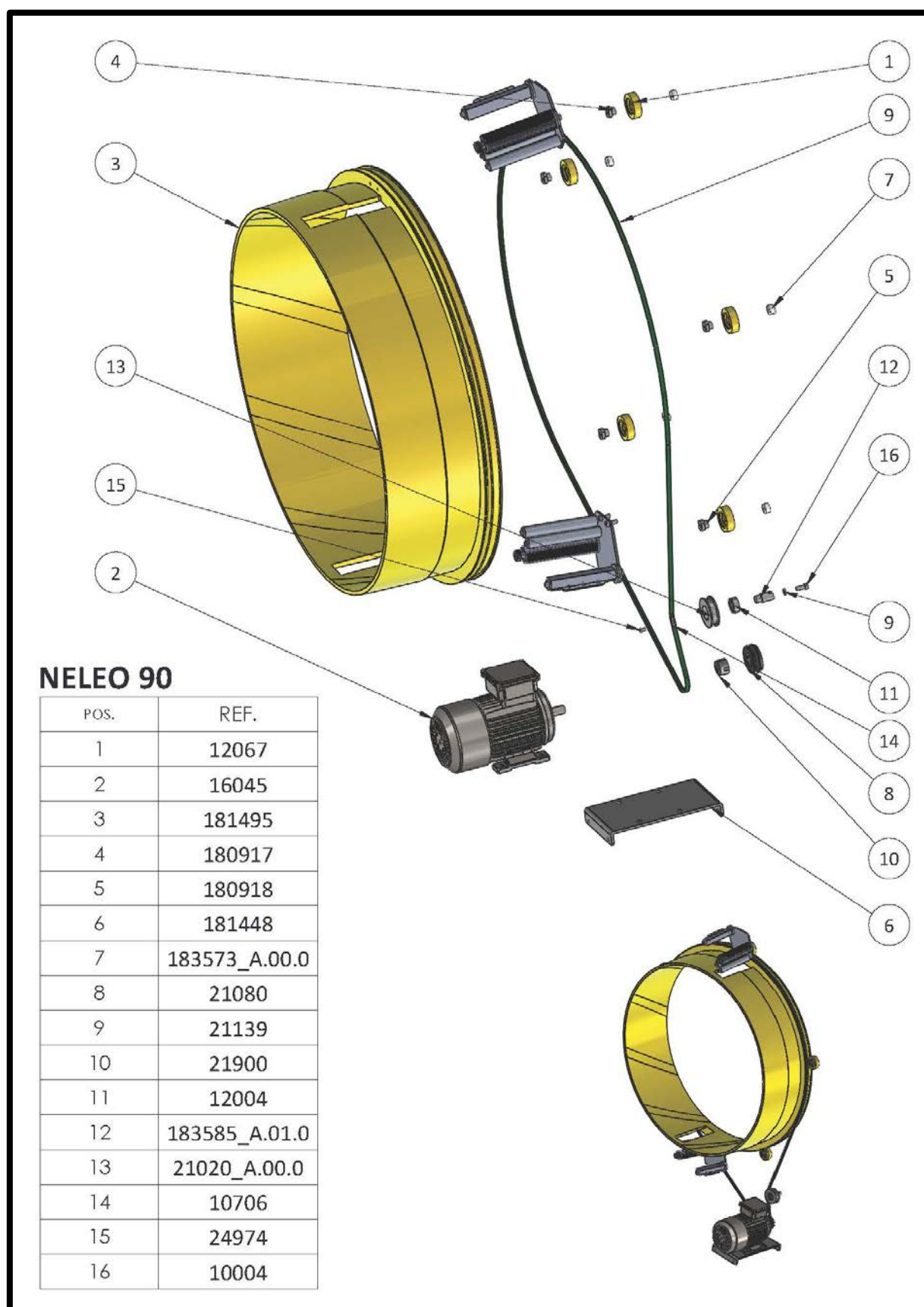



- Spool holder set

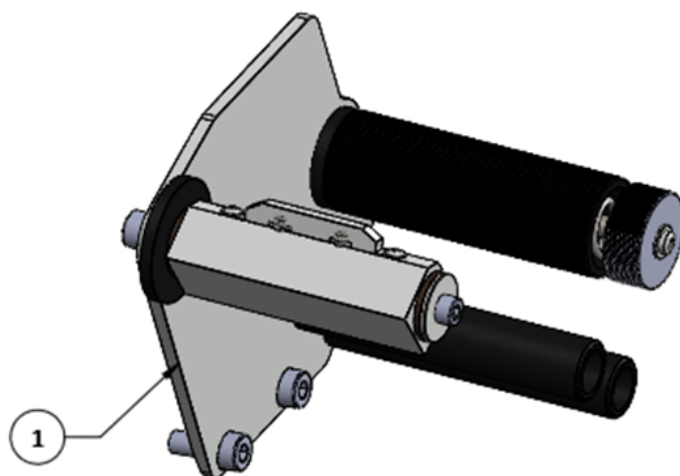

**NELEO/ATIS 050**

POS.	REF.
1	51199

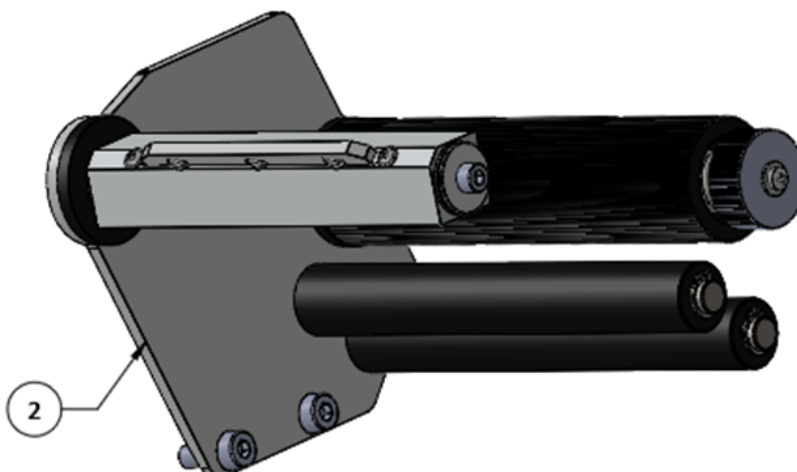

**NELEO/ATIS 090**

POS.	N.º DE PIEZA
2	51201

- Safety closing set

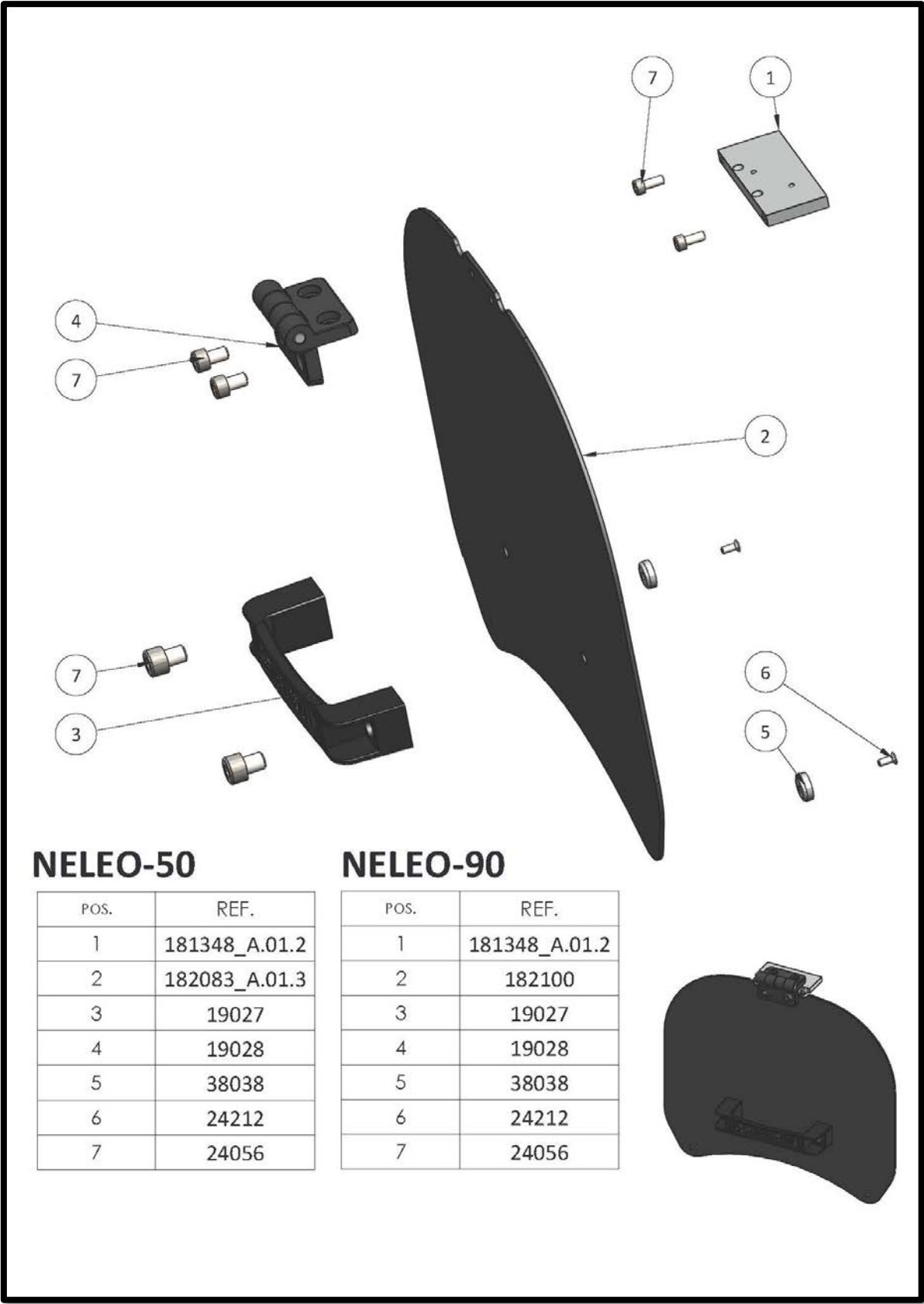

- Control panel

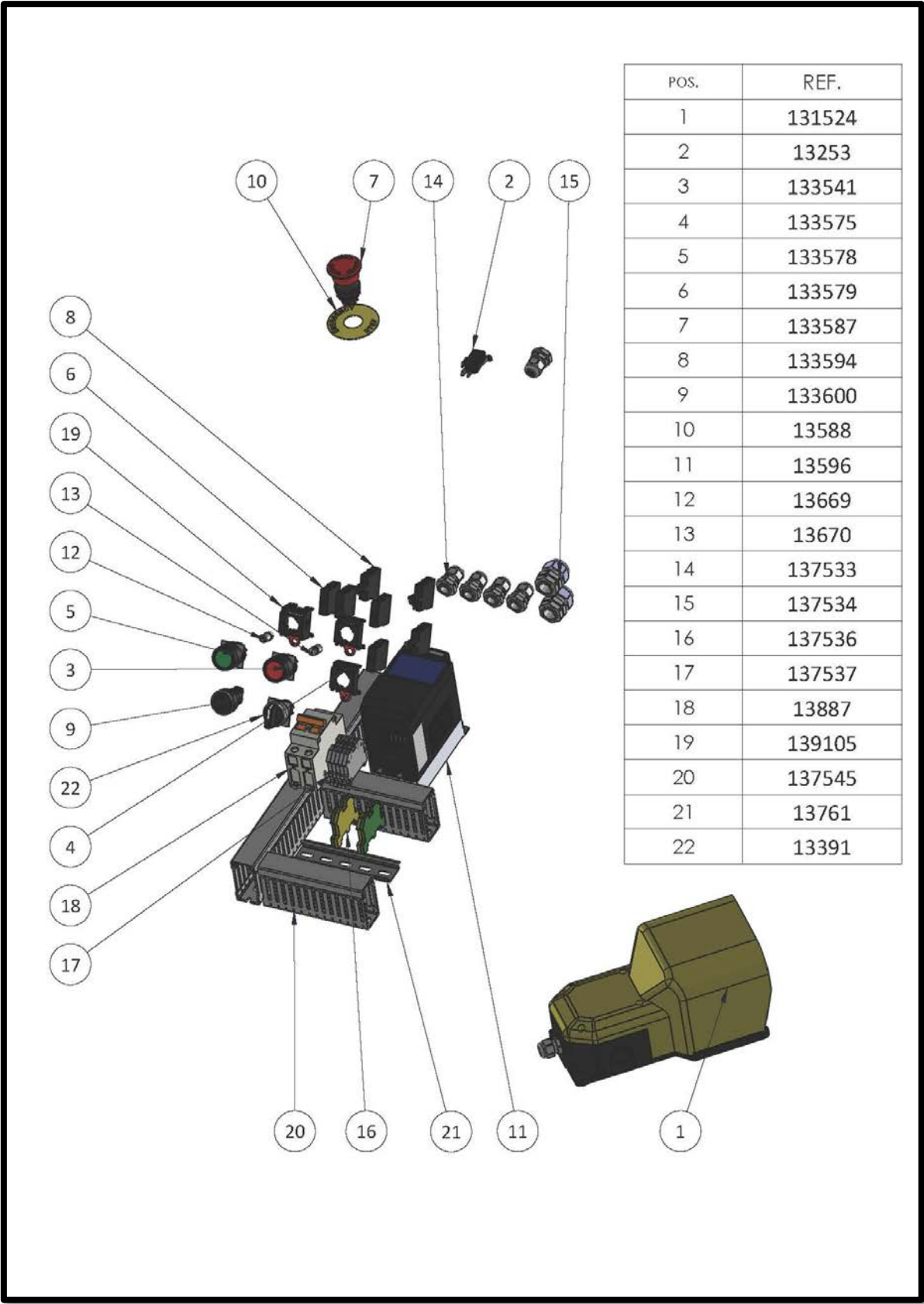

- Gravity rollers table (Optional)

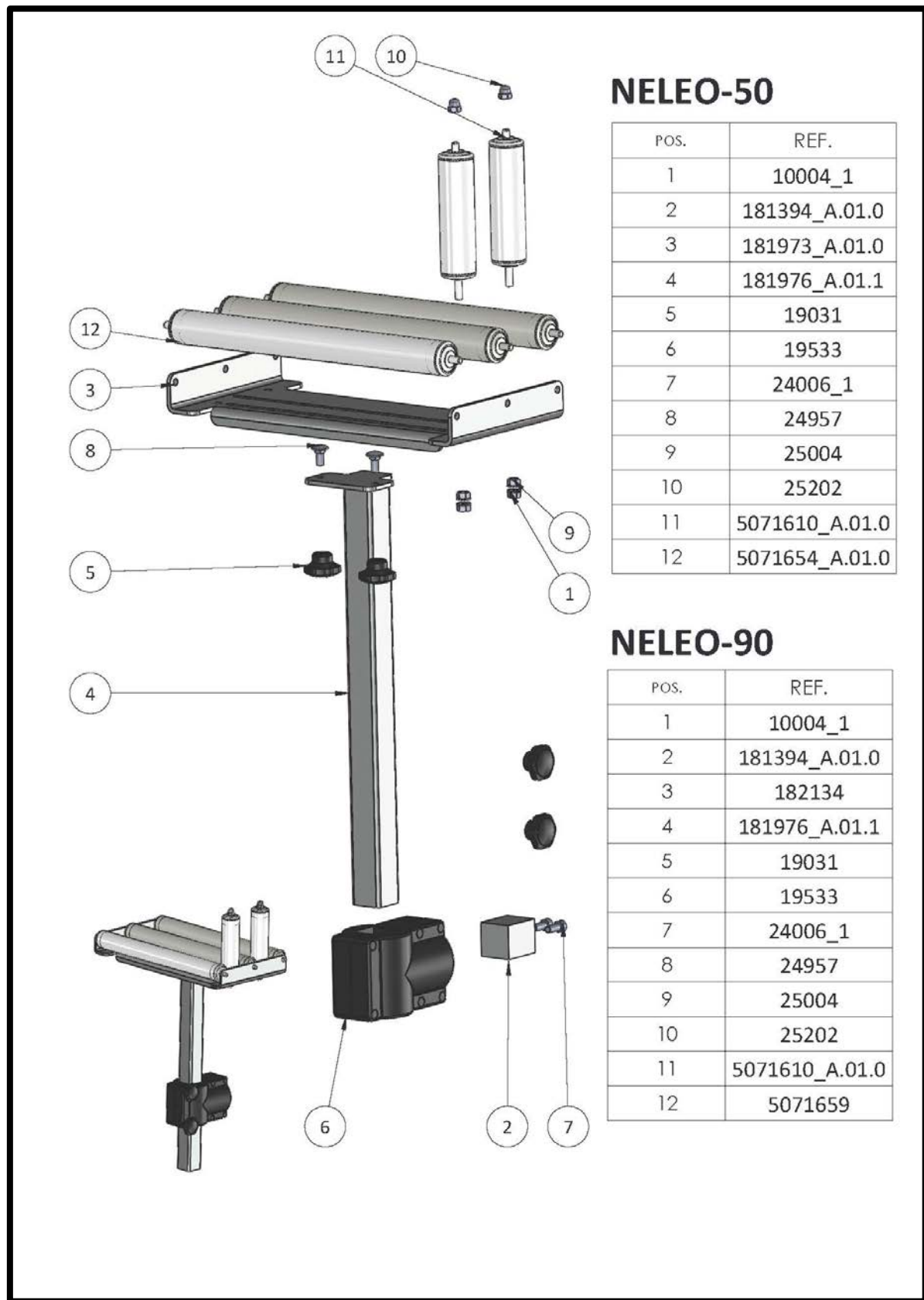

- Cutter set. (For configuration with cutting system)

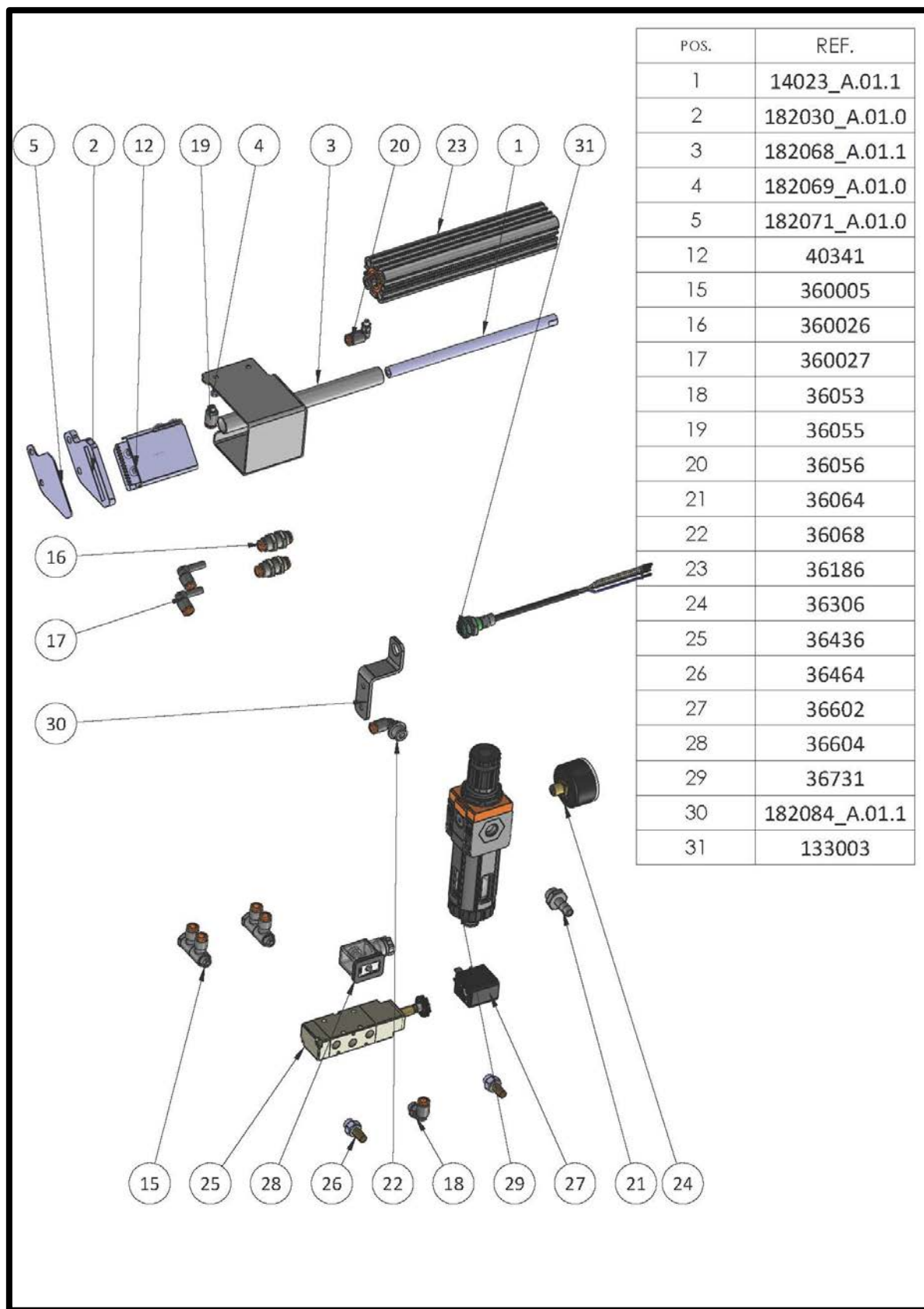

- Short products bridge (Optional)

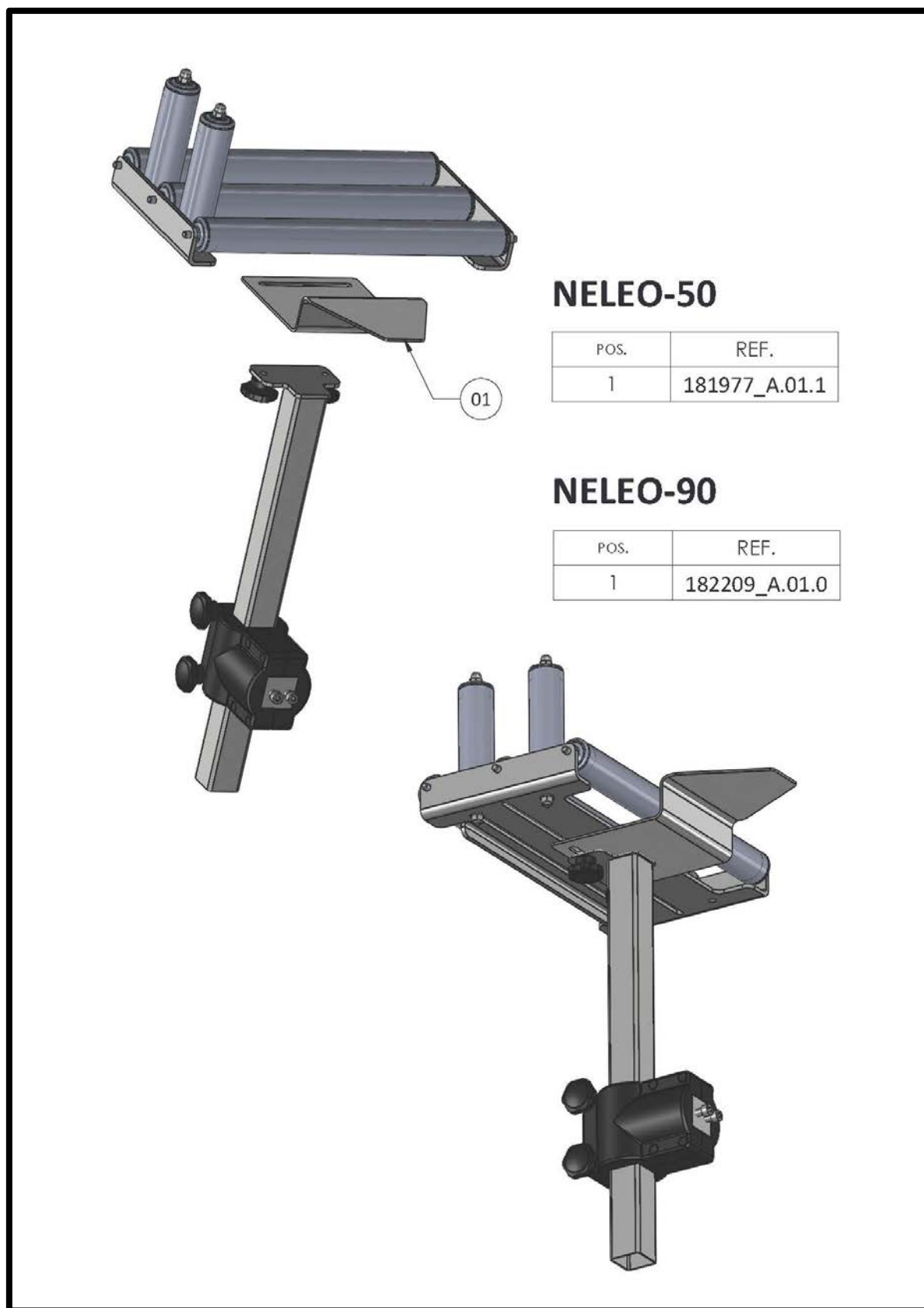



- Manual top presses (Optional)

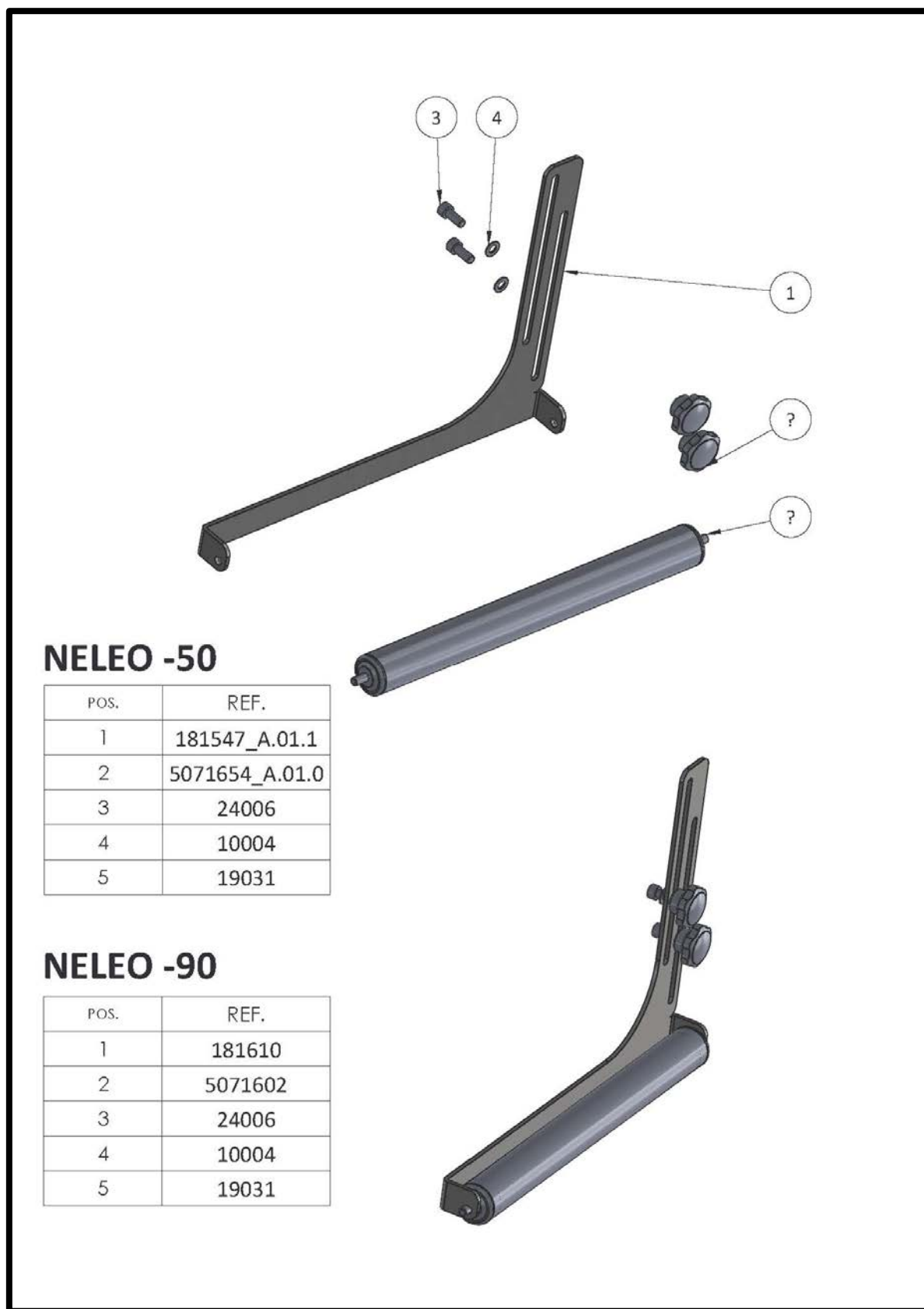



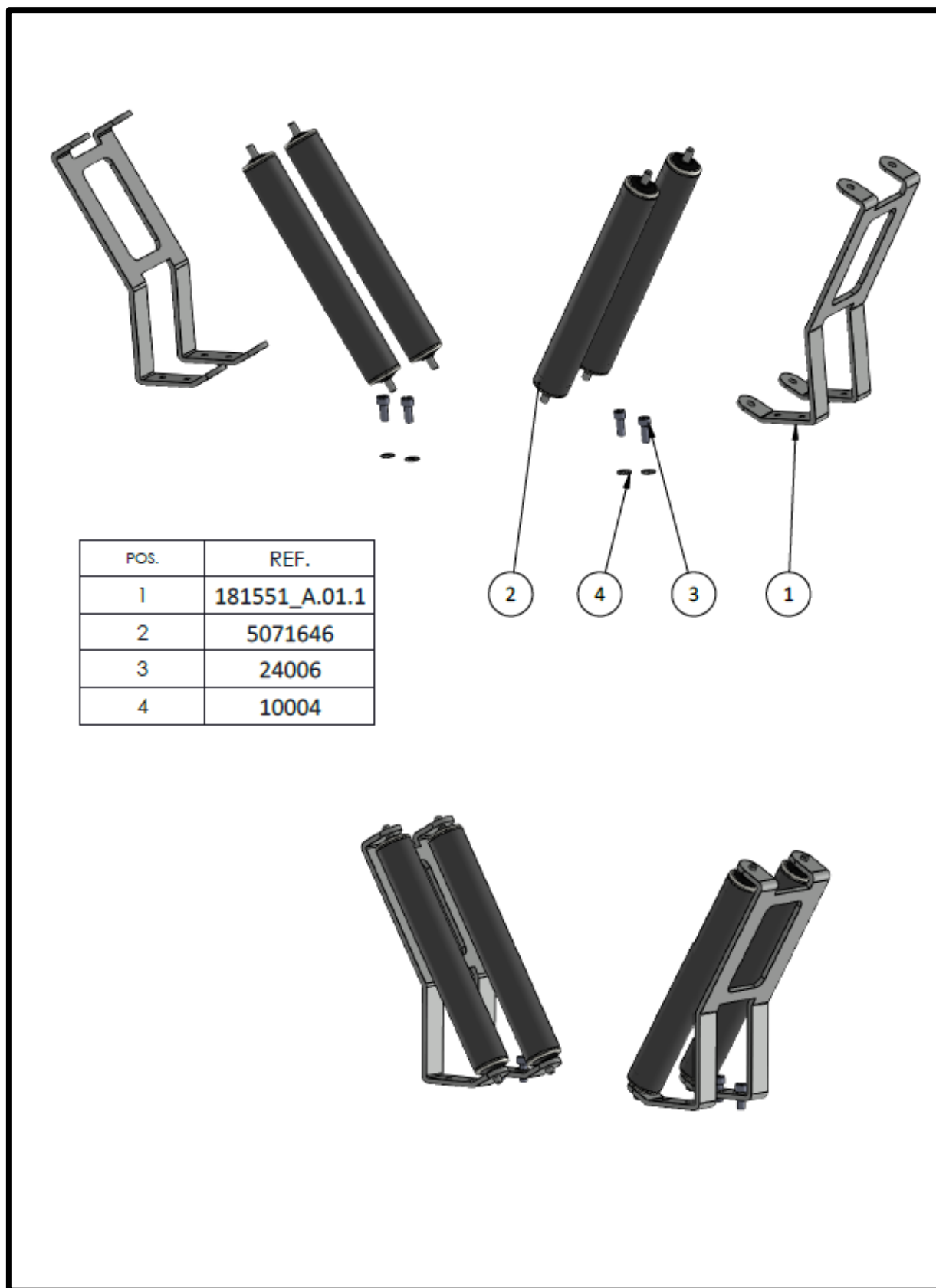

- V rollers (Optional)



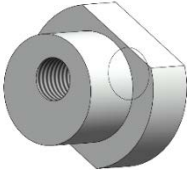
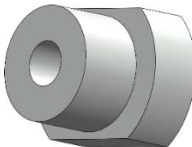

## 10.2 Spare parts list Neleo 50/90

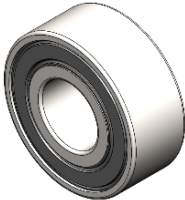
Product reference	Location	Image	Type	Quantity
19517	<ul style="list-style-type: none"> <li>Framework set.</li> <li>POS. 9</li> </ul>			4
12067	<ul style="list-style-type: none"> <li>Transmission set.</li> <li>POS. 1</li> </ul>		Wear part	4 (N50) 5 (N90)
180917	<ul style="list-style-type: none"> <li>Transmission set.</li> <li>POS. 4</li> </ul>		Wear part	2 (N50) 3 (N90)
180918	<ul style="list-style-type: none"> <li>Transmission set.</li> <li>POS. 5</li> </ul>		Wear part	2
183573	<ul style="list-style-type: none"> <li>Transmission set.</li> <li>POS. 7</li> </ul>		Wear part	4 (N50) 5 (N90)
21140 (N50) 21139 (N90)	<ul style="list-style-type: none"> <li>Transmission set.</li> <li>POS. 9</li> </ul>		Wear part	1
12004	<ul style="list-style-type: none"> <li>Transmission set.</li> <li>POS. 11</li> </ul>		Wear part	1

Product reference	Location	Image	Type	Quantity
51199 (N50) 51201 (N90)	<ul style="list-style-type: none"> <li>• Spool holder set.</li> <li>• POS. 01</li> </ul>		Wear part	2
19028	<ul style="list-style-type: none"> <li>• Safety closing set.</li> <li>• POS. 4</li> </ul>			1
13253	<ul style="list-style-type: none"> <li>• Safety closing set.</li> <li>• POS. 5</li> </ul>			1
131524	<ul style="list-style-type: none"> <li>• Control panel.</li> <li>• POS 1</li> </ul>			1
133579	<ul style="list-style-type: none"> <li>• Control panel.</li> <li>• POS. 6</li> </ul>			2
133600	<ul style="list-style-type: none"> <li>• Control panel.</li> <li>• POS. 9</li> </ul>			1
19533	<ul style="list-style-type: none"> <li>• Gravity rollers table.</li> <li>• POS. 6</li> </ul>			1

Product reference	Location	Image	Type	Quantity
5071610 (N50) 5071660 (N90)	<ul style="list-style-type: none"> <li>Gravity rollers table.</li> <li>POS. 11</li> </ul>		Wear part	2
5071645 (N50) 5071659 (N90)	<ul style="list-style-type: none"> <li>Gravity rollers table.</li> <li>POS. 12</li> </ul>		Wear part	2
<ul style="list-style-type: none"> <li>For configuration with cutting system</li> </ul>				
13519	<ul style="list-style-type: none"> <li>Cutter set.</li> <li>POS.</li> </ul>			1
40341	<ul style="list-style-type: none"> <li>Cutter set.</li> <li>POS. 12</li> </ul>		Wear part	1
36186	<ul style="list-style-type: none"> <li>Cutter set.</li> <li>POS. 23</li> </ul>			2
36436	<ul style="list-style-type: none"> <li>Cutter set.</li> <li>POS. 25</li> </ul>			1

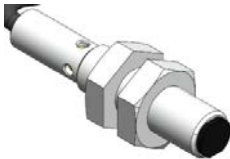
Product reference	Location	Image	Type	Quantity
36602	<ul style="list-style-type: none"> <li>Cutter set.</li> <li>POS. 27</li> </ul>			1
13291	<ul style="list-style-type: none"> <li>Cutter set.</li> <li>POS. 31</li> </ul>			1

#### PLASTICBAND AFTER SALES CUSTOMER SERVICE

Phone: +34 938 495 722  
Mobile phone: +34 630 299 839  
@ [service@plasticband.com](mailto:service@plasticband.com)

# 11

## Electrical outline

**PLASTICBAND®**  
Packaging Systems Innovation

DRAFT:	NELEO 50/90	Nº SERIAL:	SN-0000
Nº OF:	OF-0000	PIC:	NEO
VOLTA TENSORE:	210V AC	OPERATING PANEL:	11 A
ORDER VOLTAGE:	24V DC	CLIENT:	PLASTICBAND
ARTN. ISS:	ABRIL 2020	PREPARED BY:	3

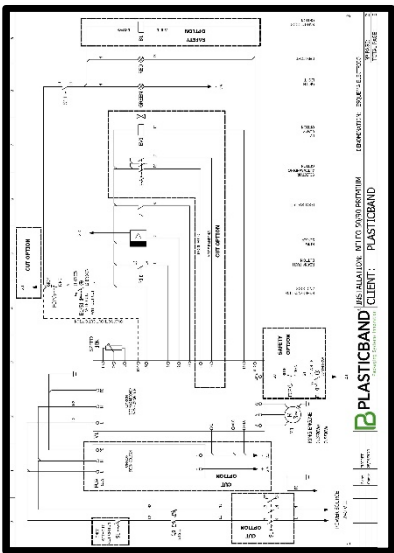

**PLASTICBAND®**  
Packaging Systems Innovation

INSTALLATION:	NELEO 50/90	CLIENT:	PLASTICBAND
DATE:	ABRIL 2020	BY:	3

# **PLASTICBAND®**

Packaging Systems Innovation

<b>DRAFT:</b>	NELEO 50/90		
<b>Nº OF:</b>	OF-0000	<b>Nº SERIAL:</b>	SN-0000
<b>WORK TENSION:</b>	240V AC	<b>PLC:</b>	MX2
<b>DRIVER VOLTAGE:</b>	24V DC	<b>OPERATING PANEL:</b>	N / A
<b>CLIENT:</b>	PLASTICBAND		
<b>ADDRESS:</b>			
<b>PREPARED ON:</b>	ABRIL 2020	<b>NUMBER OF PAGES:</b>	3

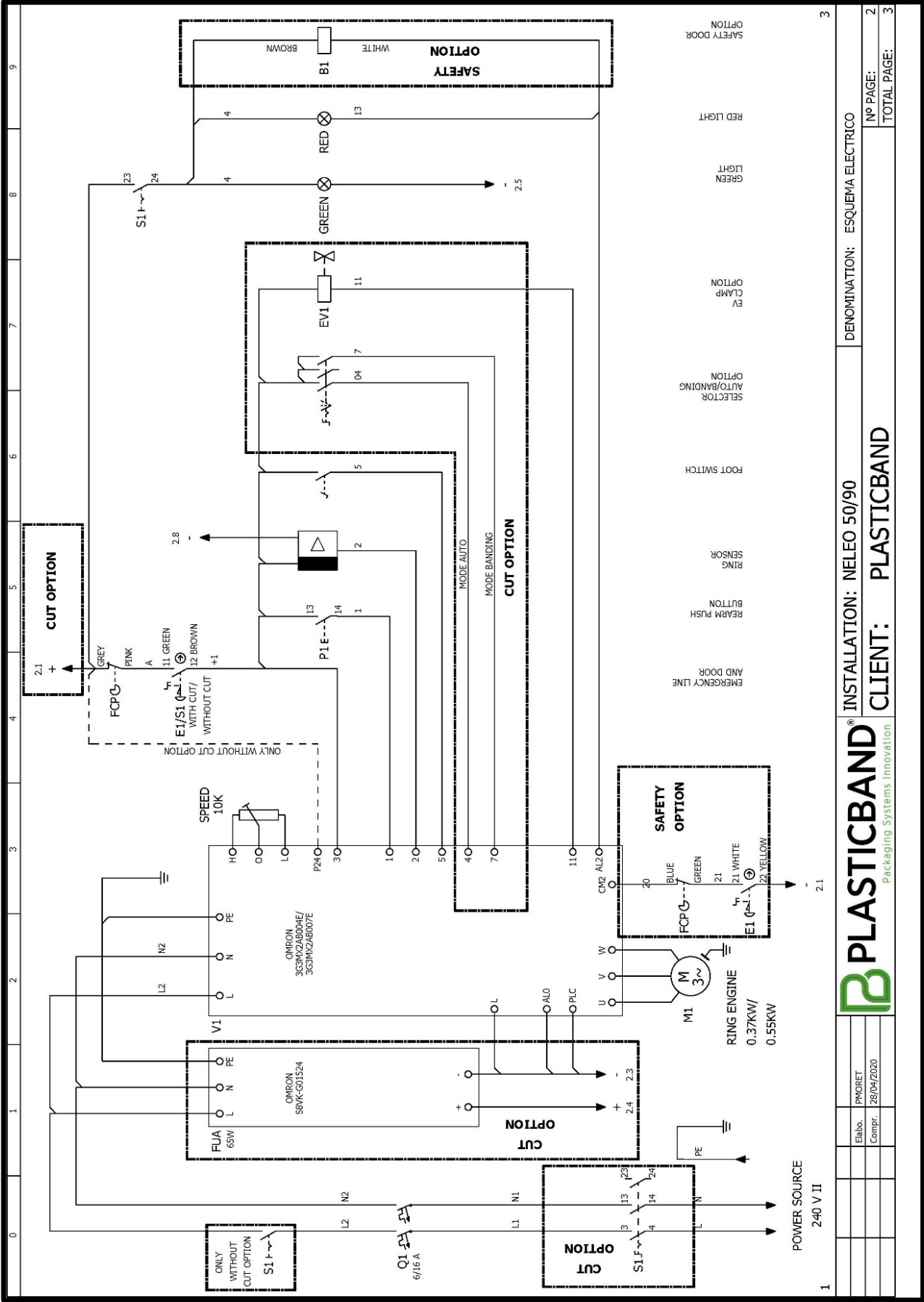

0123456789

2

TERMINAL BLOCK X1

--	--	--	--	--	--	--	--	--	--	--	--	--	--	--	--	--	--	--	--	--	--	--	--	--	--	--	--	--	--	--	--	--	--	--	--	--	--	--	--	--	--	--	--	--	--	--	--	--	--	--	--	--	--	--	--	--	--	--	--	--	--	--	--	--	--	--	--	--	--	--	--	--	--	--	--	--	--	--	--	--	--	--	--	--	--	--	--	--	--	--	--	--	--	--	--	--	--	--	--	--	--	--	--	--	--	--	--	--	--	--	--	--	--	--	--	--	--	--	--	--	--	--	--	--	--	--	--	--	--	--	--	--	--	--	--	--	--	--	--	--	--	--	--	--	--	--	--	--	--	--	--	--	--	--	--	--	--	--	--	--	--	--	--	--	--	--	--	--	--	--	--	--	--	--	--	--	--	--	--	--	--	--	--	--	--	--	--	--	--	--	--	--	--	--	--	--	--	--	--	--	--	--	--	--	--	--	--	--	--	--	--	--	--	--	--	--	--	--	--	--	--	--	--	--	--	--	--	--	--	--	--	--	--	--	--	--	--	--	--	--	--	--	--	--	--	--	--	--	--	--	--	--	--	--	--	--	--	--	--	--	--	--	--	--	--	--	--	--	--	--	--	--	--	--	--	--	--	--	--	--	--	--	--	--	--	--	--	--	--	--	--	--	--	--	--	--	--	--	--	--	--	--	--	--	--	--	--	--	--	--	--	--	--	--	--	--	--	--	--	--	--	--	--	--	--	--	--	--	--	--	--	--	--	--	--	--	--	--	--	--	--	--	--	--	--	--	--	--	--	--	--	--	--	--	--	--	--	--	--	--	--	--	--	--	--	--	--	--	--	--	--	--	--	--	--	--	--	--	--	--	--	--	--	--	--	--	--	--	--	--	--	--	--	--	--	--	--	--	--	--	--	--	--	--	--	--	--	--	--	--	--	--	--	--	--	--	--	--	--	--	--	--	--	--	--	--	--	--	--	--	--	--	--	--	--	--	--	--	--	--	--	--	--	--	--	--	--	--	--	--	--	--	--	--	--	--	--	--	--	--	--	--	--	--	--	--	--	--	--	--	--	--	--	--	--	--	--	--	--	--	--	--	--	--	--	--	--	--	--	--	--	--	--	--	--	--	--	--	--	--	--	--	--	--	--	--	--	--	--	--	--	--	--	--	--	--	--	--	--	--	--	--	--	--	--	--	--	--	--	--	--	--	--	--	--	--	--	--	--	--	--	--	--	--	--	--	--	--	--	--	--	--	--	--	--	--	--	--	--	--	--	--	--	--	--	--	--	--	--	--	--	--	--	--	--	--	--	--	--	--	--	--	--	--	--	--	--	--	--	--	--	--	--	--	--	--	--	--	--	--	--	--	--	--	--	--	--	--	--	--	--	--	--	--	--	--	--	--	--	--	--	--	--	--	--	--	--	--	--	--	--	--	--	--	--	--	--	--	--	--	--	--	--	--	--	--	--	--	--	--	--	--	--	--	--	--	--	--	--	--	--	--	--	--	--	--	--	--	--	--	--	--	--	--	--	--	--	--	--	--	--	--	--	--	--	--	--	--	--	--	--	--	--	--	--	--	--	--	--	--	--	--	--	--	--	--	--	--	--	--	--	--	--	--	--	--	--	--	--	--	--	--	--	--	--	--	--	--	--	--	--	--	--	--	--	--	--	--	--	--	--	--	--	--	--	--	--	--	--	--	--	--	--	--	--	--	--	--	--	--	--	--	--	--	--	--	--	--	--	--	--	--	--	--	--	--	--	--	--	--	--	--	--	--	--	--	--	--	--	--	--	--	--	--	--	--	--	--	--	--	--	--	--	--	--	--	--	--	--	--	--	--	--	--	--	--



# 12 Pneumatical outline (For configuration with cutting system)

